

There are two external openings on the East face of the building that could be considered as principle rooms, these are the windows of bedroom 2 & 3. In relation to the neighbouring property, they each sit 17.975m from the closest window at angles of 60° & 59.19° .

Referring to the diagram (Figure 1) and the drawing of the proposed building (Figure 2), the angles and distances are displayed.

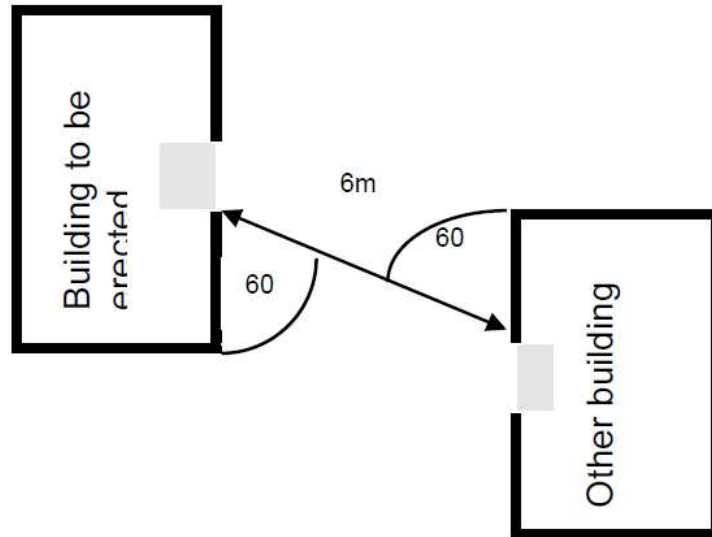

Figure 1

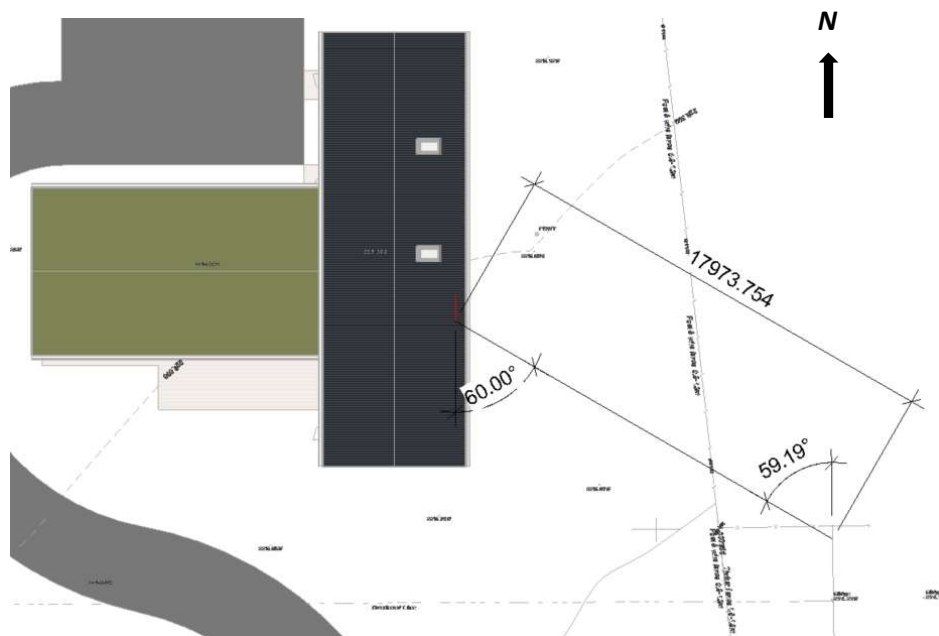

Figure 2

Using Figure 3, and the two angles of 60° & 59.19°, it can be determined that a distance of 6 meters between the two buildings windows would suffice. With the actual distance sitting at 17.973m, it is well above this and therefore will not cause any privacy concerns through overlooking.

TABLE 1

		<i>Angle (in degrees) at window of building to be erected not more than</i>									
		90	80	70	60	50	40	30	20	10	0
<i>Angle at window of any other building not more than</i>	90	18	18	18	18	13	9	6	4	3	2
	80	18	18	18	13	9	6	4	3	2	
	70	18	18	13	9	6	4	3	2		
	60	18	13	9	6	4	3	2			
	50	13	9	6	4	3	2				
	40	9	6	4	3	2					
	30	6	4	3	2						
	20	4	3	2							
	10	3	2								
	0	2									

DISTANCES IN METRES

Figure 3